



2900 Selma Highway
Montgomery, AL 36108 USA
Tel: 334-386-5400 Fax: 334-386-5450

SERVICE BULLETIN

SERVICE BULLETIN No. 082

HEATER COMBUSTION BLOWER INLET ADAPTER INSPECTION

1. Planning Information

A. Effectivity

- (1) Janitrol Aero heater combustion air blower inlet adapter P/N 84D38-(3, 4) manufactured by Hartzell Engine Technologies (HET) are affected by this Service Bulletin (SB).
- (2) The combustion air blower inlet adapter P/N 84D38-(3, 4) is a sub-component of the heater combustion air blower assembly. Combustion air blower assemblies affected by this SB are shown in Table 1.
- (3) All serial numbers are affected by this Service Bulletin.

NOTE: Table 1 is for reference only and is not an all-inclusive list of combustion blowers affected by this SB. It is the responsibility of the owner/operator to verify whether an affected combustion air blower may be installed.

WARNING: DO NOT USE OBSOLETE OR OUTDATED INFORMATION. PERFORM ALL INSPECTIONS OR WORK IN ACCORDANCE WITH THE MOST RECENT REVISION OF THIS SERVICE BULLETIN. INFORMATION CONTAINED HEREIN MAY BE SIGNIFICANTLY CHANGED FROM EARLIER REVISIONS. FAILURE TO COMPLY WITH THIS SERVICE BULLETIN OR THE USE OF OBSOLETE INFORMATION MAY CREATE AN UNSAFE CONDITION THAT MAY RESULT IN DEATH, SERIOUS BODILY INJURY, AND/OR SUBSTANTIAL PROPERTY DAMAGE. REFER TO THE JANITROL AERO WEBSITE, WWW.JANITROL.AERO, FOR THE MOST RECENT REVISION LEVEL OF THIS SERVICE BULLETIN.

B. Concurrent Requirements

- (1) None

C. Reason

- (1) Heater combustion air blower inlet adapter P/N 84D38-(3, 4) could contain a condition that allows delamination of the high-temperature electrical tape from the inlet adapter. This condition compromises the electrical insulation properties between the pre-heater and the inlet adapter housing. Should delamination occur and the tape come in contact with the heater strip, smoke and/or fumes could be introduced into the compartment.
- (2) This SB is to advise the field of a known condition and to supply inspection criteria to identify affected heater combustion air blowers.

SERVICE BULLETIN

SERVICE BULLETIN No. 082

HEATER COMBUSTION BLOWER INLET ADAPTER INSPECTION

D. Description

- (1) This Bulletin provides Instructions for Continued Airworthiness (ICA).

E. Compliance

- (1) Compliance with section 3.A of this SB is required within fifty (50) hours time-in-service after the effective date of this SB or at the next scheduled annual inspection, whichever occurs first.
- (2) For affected heater combustion blower assemblies in inventory, return within 30 days from the original issue date of this Service Bulletin or prior to installation, whichever occurs first.
- (3) Compliance with the Accomplishment Instructions is the terminating action for this SB.

F. Approval

- (1) FAA acceptance has been obtained on the technical data in this publication that affects type design.

G. Manpower

- (1) Up to two (2.0) hours labor for inlet adapter removal, inspection, replacement of high-temperature electrical tape, and installation of the inlet adapter.

H. References

- (1) HET 24E25-1 Rev. D or later FAA approved revision, *B-Series Heater Overhaul and Maintenance Manual*.
- (2) Applicable Aircraft Service Instructions or Maintenance Manual.
- (3) Applicable Aircraft AFM or POH.

I. Weight and Balance

- (1) No Change

2. Materials Required

A. One roll of high temperature tape P/N 11E63-1 procured from Hartzell Engine Technologies.

- (1) Saint-Gobain manufacturer part number (MPN) CHR G565. Purchased from various suppliers.

SERVICE BULLETIN

SERVICE BULLETIN No. 082

HEATER COMBUSTION BLOWER INLET ADAPTER INSPECTION

| Combustion Air Blower P/N | Inlet Adapter P/N | Original High Temperature Tape P/N | Replacement High Temperature Tape P/N |
|-------------------------------|-------------------|------------------------------------|---------------------------------------|
| 09E55-1 | 84D38-3 | 11E63-2 (pre-cut to length) | 11E63-1 (roll) |
| 10E26-1 10E26-2 | | | |
| 10E26-3 10E26-4 10E26-5 | 84D38-4 | 11E63-2 (pre-cut to length) | 11E63-1 (roll) |

Table 1 - Combustion Air Blower Assembly Effectivity

3. Accomplishment Instructions

WARNING 1: THIS PROCEDURE MUST BE PERFORMED BY COMPETENT AND QUALIFIED PERSONNEL WHO ARE FAMILIAR WITH THE AIRFRAME AND ENGINE SYSTEM MAINTENANCE. FAILURE TO DO SO MAY RESULT IN PHYSICAL INJURY, EQUIPMENT DAMAGE AND/OR ECONOMIC LOSS.

WARNING 2: DO NOT USE OBSOLETE OR OUTDATED INFORMATION. PERFORM ALL INSPECTIONS OR WORK IN ACCORDANCE WITH THE MOST RECENT REVISION OF THIS SERVICE BULLETIN. INFORMATION CONTAINED HEREIN MAY BE SIGNIFICANTLY CHANGED FROM EARLIER REVISIONS. FAILURE TO COMPLY WITH THIS SERVICE BULLETIN OR THE USE OF OBSOLETE INFORMATION MAY CREATE AN UNSAFE CONDITION THAT MAY RESULT IN DEATH, SERIOUS BODILY INJURY, AND/OR SUBSTANTIAL PROPERTY DAMAGE. REFER TO THE JANITROL AERO WEBSITE FOR THE MOST RECENT REVISION LEVEL OF THIS SERVICE BULLETIN, WWW.JANITROL.AERO.

CAUTION: REFER TO THE APPLICABLE MANUFACTURER'S MAINTENANCE MANUALS OR SERVICE INSTRUCTIONS TO GAIN ACCESS TO THE AIRFRAME OR HEATER. IN ADDITION, ANY PREFLIGHT OR IN-FLIGHT OPERATIONAL CHECKS REQUIRE USE OF THE APPROPRIATE AFM OR POH.

SERVICE BULLETIN

SERVICE BULLETIN No. 082

HEATER COMBUSTION BLOWER INLET ADAPTER INSPECTION

A. Inspection

- (1) If previous compliance cannot be verified through aircraft or engine maintenance records, use the same references to determine if an affected heater combustion air blower has been installed. Refer to section 1.A, Effectivity.
- (2) If effectivity of the heater combustion air blower assembly cannot be established using aircraft or engine maintenance records, utilize the applicable aircraft maintenance manual to gain access to the heater and inspect the combustion air blower assembly part number against the affected part numbers found in section 1.A of this SB.
 - (a) If the combustion air blower assembly part number is affected per section 1.A, continue to 3.B. - Corrective Action.
 - (b) If the combustion air blower assembly part number is not affected per section 1.A, continue to 3.C. - Return to Service.

B. Corrective Action

Refer to Figures 1 and 2 (indexed).

- (1) Gain access to the heater assembly using applicable aircraft maintenance manual.
- (2) Remove the intake ducting (CEET, SCEET, SCAT) from the inlet adapter (1).
- (3) Disconnect the pre-heater wires from the blower assembly:
 - (a) Use a Phillips head screwdriver to remove ground screw (2) on the eyelet.
 - (b) Pull pin (3) from plug housing.
- (4) Remove Inlet adapter screw P/N 86D35-2 (4).
- (5) Remove pre-heater mounting screws P/N 86D35-2 (5).
- (6) Push grommet P/N MS35489-6 (6) into the Inlet adapter while pulling wires and pre-heater (7) through the supply air opening.
- (7) Remove insulating tape P/N 11E63-2 from the inlet adapter and discard.
- (8) Thoroughly clean area where tape was removed of all adhesive residue with isopropyl alcohol or suitable solvent.

NOTE: Ensure all tape residue is removed from the inlet adapter prior to installing new tape.

- (9) Measure, cut, and apply new tape as noted in Figure 3.

NOTE: Press the tape down firmly and smooth all wrinkles to properly secure the pressure sensitive adhesive.

SERVICE BULLETIN

SERVICE BULLETIN No. 082

HEATER COMBUSTION BLOWER INLET ADAPTER INSPECTION

- (10) Use a utility knife or equivalent to cut holes in the tape for the grommet and pre-heater installation screws.
- (11) Install the pre-heater in reverse order of removal. Torque mounting screws (5) 12-15 in. lbs.
- (12) Install the inlet adapter onto the combustion air blower assembly and secure with screw P/N 86D35-2 (4). Torque screw 12-15 in. lbs.
- (13) Connect the pre-heater ground and lead wires as shown in Figure 1.
- (14) Install intake ducting (CEET, SCEET, SCAT) onto the inlet adapter (1).
- (15) Perform a ground operational check of the heater in accordance with applicable AFM or POH.

C. Return to Service

- (1) Close all access doors and covers opened to gain access to the heater in accordance with applicable airframe and/or engine maintenance manual.

D. Maintenance Record

- (1) Make a logbook entry noting compliance with this Service Bulletin.

4. Contact Information

A. Contact HET Product Support for all communications regarding the technical content of this Service Bulletin.

- (1) Phone +1.334.386.5400 (Option 2)
- (2) Fax +1.334.386.5450
- (3) E-mail at techsupport@HartzellEngineTech.com
- (4) Address

Hartzell Engine Technologies LLC - ATTN: Product Support
2900 Selma Highway
Montgomery, AL 36108
USA

SERVICE BULLETIN

SERVICE BULLETIN No. 082

HEATER COMBUSTION BLOWER INLET ADAPTER INSPECTION

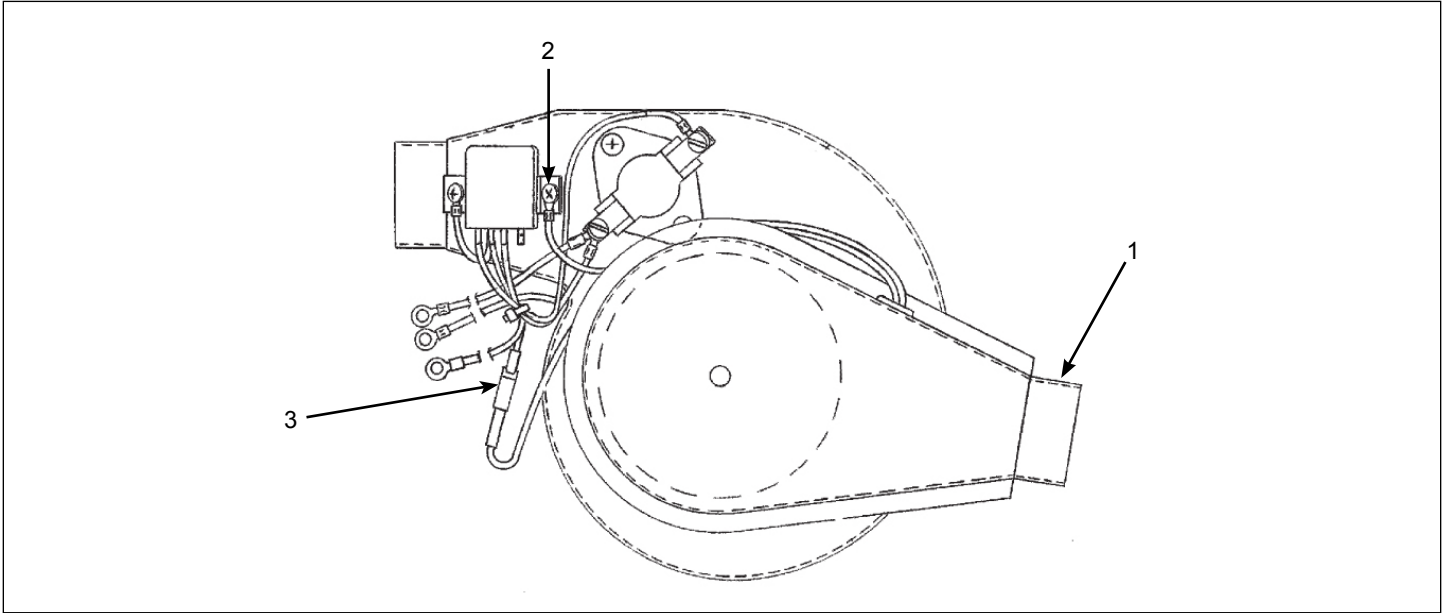

Figure 1 - Combustion Air Blower Assembly

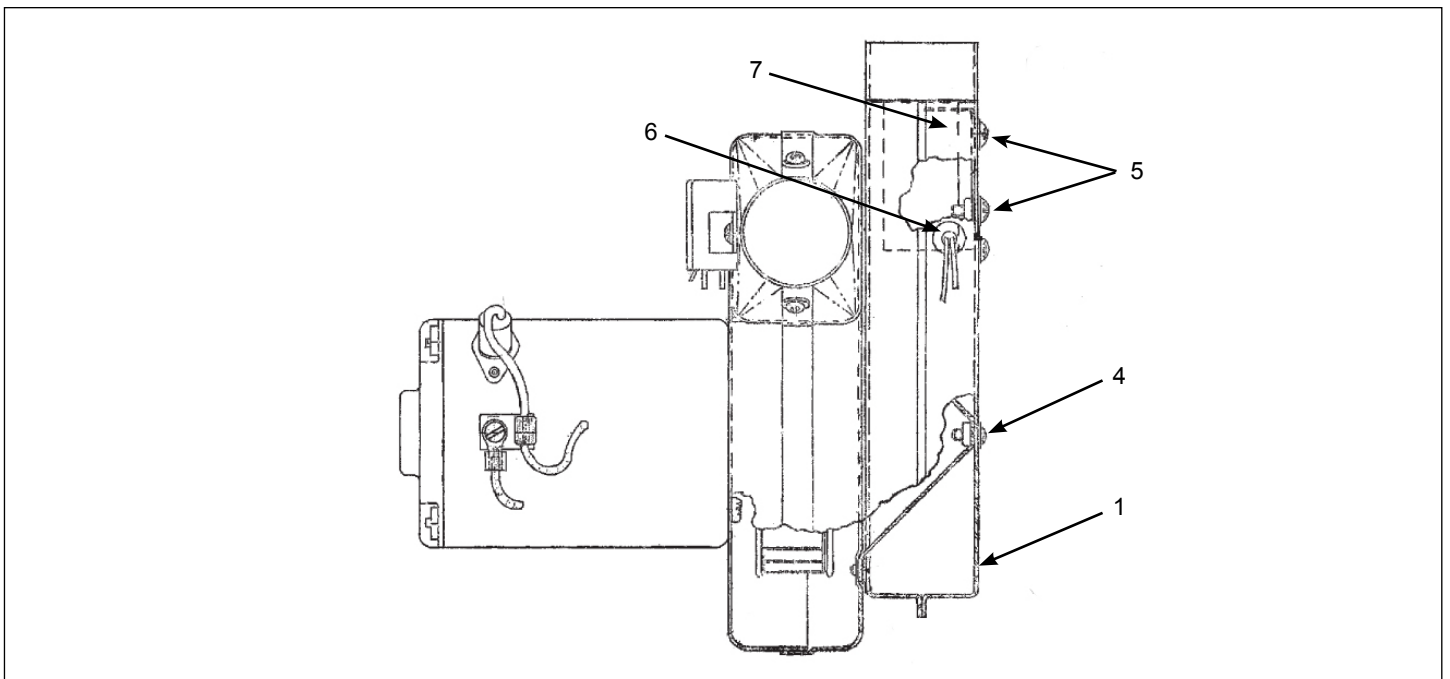

Figure 2 - Combustion Air Blower Assembly

SERVICE BULLETIN

SERVICE BULLETIN No. 082

HEATER COMBUSTION BLOWER INLET ADAPTER INSPECTION

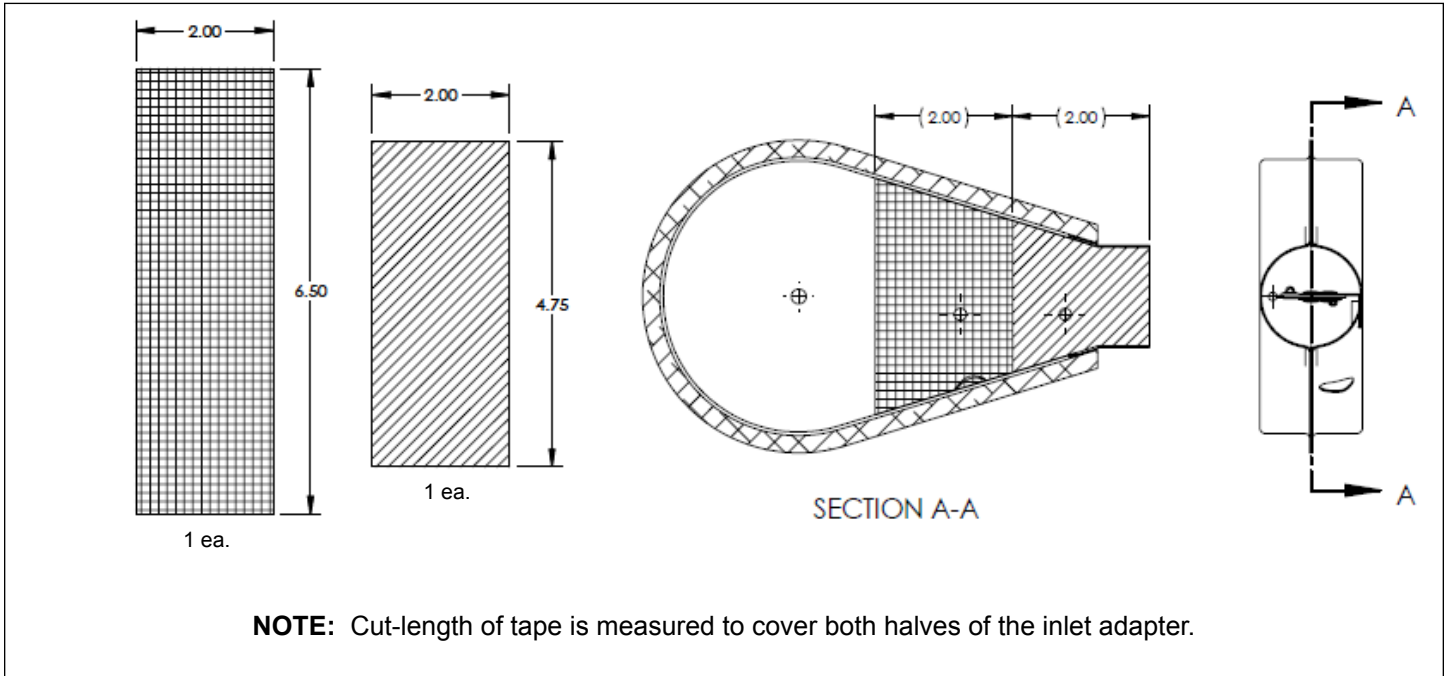

Figure 3 - Inlet Adapter Tape Installation

Service Bulletin Appendix

Service Bulletin 082

HEATER COMBUSTION BLOWER INLET ADAPTER INSPECTION

1. ELIGIBILITY:

- A. Janitrol Aero heater combustion air blower inlet adapter P/N 84D38-(3, 4) manufactured by Hartzell Engine Technologies (HET) are affected by Service Bulletin (SB) 082.
- B. The combustion air blower inlet adapter P/N 84D38-(3, 4) is a sub-component of the heater combustion air blower assembly. Combustion air blower assemblies affected are shown in Table 1 of SB 082.

2. COMMERCIAL ASSISTANCE PROGRAM:

The following will be provided with the submission of a completed SB 082 Claim Form, copies of invoices showing breakdown of labor charges and log book entries. **Any commercial assistance or other consideration shall expire twelve (12) calendar months from the original published date of SB 082.**

- A. Required replacement materials found in Table 1 of SB 082.
- B. Labor for removal and installation heater combustion blower inlet adapter of an eligible combustion air blower assembly will be paid at a shop rate of up to US\$75 per hour, not to exceed hours specified below.
 - (1) Up to 1.0 hour labor allowance for removal and installation of the heater combustion blower inlet adapter per affected combustion air blower assembly.
 - (2) Up to 1.0 hour labor allowance for replacement of insulating tape per combustion air blower adapter.

3. COMMERCIAL ASSISTANCE ADMINISTRATION:

- A. Complete the Service Bulletin 082 Claim Form attached to this appendix per affected combustion air blower assembly.
 - (1) Mail, e-mail, or fax the SB 082 Claim Form(s) to the attention of Product Support as indicated on the Service Bulletin Claim Form.
- B. For labor and material charges:
 - (1) Aircraft service facility to submit an invoice up to the amount specified in section 2.B.(1) and copies of logbook entries for reimbursement.

4. WARRANTY STATEMENT:

- A. The sole warranty for the actions of SB 082 is contained in the HET Limited Warranty Policy issued with the purchase of each heater combustion blower or piece part (see terms and conditions therein).
- B. Commercial assistance may apply as stated in this Appendix.
- C. Issuance of SB 082 in no way constitutes an implied or expressed warranty of any kind.
- D. This publication does not imply or state any responsibility for the workmanship of any person or entity performing work or maintenance on the aircraft cabin heating system.

Service Bulletin Appendix

Service Bulletin 082

HEATER COMBUSTION BLOWER INLET ADAPTER INSPECTION

5. CONTACT INFORMATION:

A. Contact HET Product Support for all communications regarding the technical content of this Service Bulletin.

- (1) Phone +1.334.386.5441
- (2) Fax +1.334.386.5410.
- (3) E-mail at techsupport@HartzellEngineTech.com.
- (4) Address

Hartzell Engine Technologies LLC
2900 Selma Highway
Montgomery, AL 36108, USA.



Service Bulletin Appendix

Service Bulletin 082

Heater Combustion Blower Inlet Adapter Inspection

2900 Selma Highway
Montgomery, AL 36108 USA
Tel: 334-386-5400 Fax: 334-386-5450

SB 082 CLAIM FORM

Owner information

Name: _____ Date: _____ Tel: _____ Fax: _____
Company Name: _____ E-mail: _____
Address: _____
City: _____ State: _____ Postal Code: _____
Country: _____

Aircraft Service Facility information

Name: _____ Date: _____ Tel: _____ Fax: _____
Company Name: _____ E-mail: _____
Address: _____
City: _____ State: _____ Postal Code: _____
Country: _____
Aircraft Mfg: _____ Model: _____ Time in Service: _____ S/N: _____
Engine: _____ Model: _____ Time in Service: _____ S/N: _____

Aircraft Heater Service Facility information

Name: _____ Date: _____ Tel: _____ Fax: _____
Company Name: _____ E-mail: _____
Address: _____
City: _____ State: _____ Postal Code: _____
Country: _____

Product or Component Information

Nomenclature: Heater Comb. Air Blower Assy. Part Number: _____
Serial Number: _____
Part Time in Service: _____ Date Installed: _____ Date Removed: _____

Send this SB 082 Claim Form to:
Hartzell Engine Technologies Product Support
Fax: +1.334.386.5450
E-mail: techsupport@hartzellenginetech.com

RMA Number:

(write in HET assigned RMA number)

Hartzell Use Only - do not write below this line.

Warranty No: _____ Authorized by: _____